

# BH-BOC

## Branch-off clip for telecommunication cable branch connection

### Features/Applications:

BH-BOC branch-off clip it is casted by aluminum alloy which resists to high temperature and coating by high temperature paint on the surface, the middle toe is molding by EVA or PA hot melting adhesive. It is use together with the heat shrinkable tube as branching in the communication cable/railway signal cable joint connection, it could be divided into two, three and so on, to achieve a variety of cable perfect branch



Specification & Dimensions

Model No.	Applicable cable pairs	Applicable heat shrinkable tube Dia.(mm)
BH-BOC-S	≤200	40-75
BH-BOC-M	200-400	75-105
BH-BOC-L	400-1200	105-140
BH-BOC-XL	≥1200	≥140

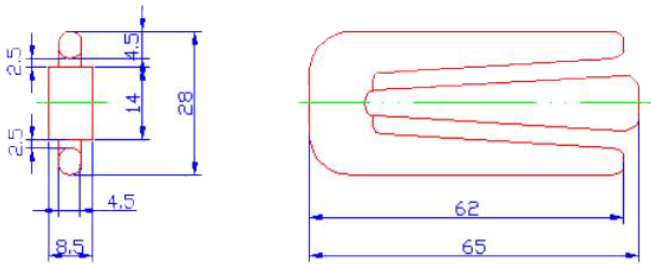

BH-BOC-S Branch off clip (small size)

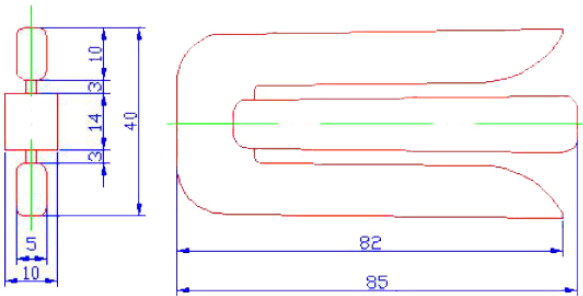

BH-BOC-M branch off clip (middle size)

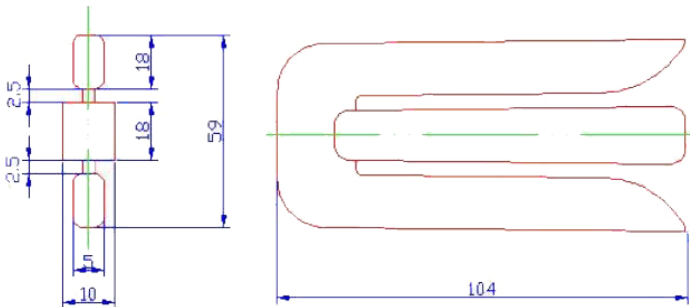

BH-BOC-L branch off clip (large size)

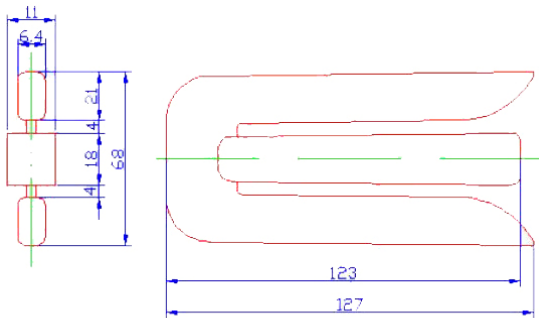

BH-BOC-XL branch off clip (extra large size)